



ADJUSTMENT KEY

FOR CLEMAN® RISER PEDESTAL



BENEFITS

- Solid.
- Good grip.

✓ APPLICATIONS

- Corrects up to 1 mm of misalignment (equivalent to a quarter turn) once the paving has been laid.
- Pre-adjust the height of the risers during the installation (one turn = 4 mm).

🧠 RECOMMENDATIONS

- For pedestrian use only.
- Outdoor use only.
- At the slightest resistance, stop turning the key and finish manually using the nut.
- The key cannot be used with riser pedestals located on the long edge of rectangular paving. Rectangular or square format paving requiring a longitudinal riser pedestal.
- For IFU, see the website.

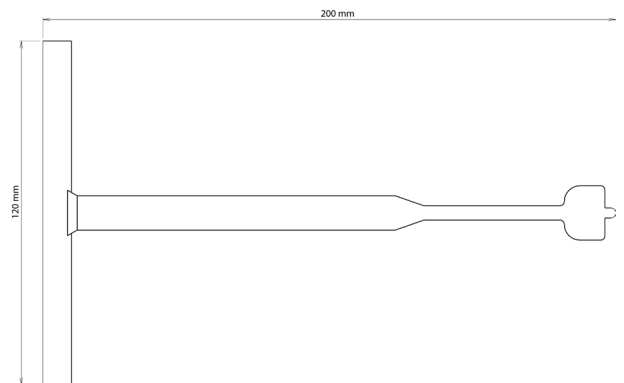

🔍 TECHNICAL DETAILS

- Material : Steel
- Colour : Metal grey
- Length : 200 mm
- Width : 120 mm
- Thickness tip: 4 mm

📦 PACKING

- Per unit (504 boxes per pallet - Stackable)

Document protected by copyright. Any reproduction, copy, extraction, reuse in others publications, translation or adaptation, display, distribution or modification, in whole or in part, without the written consent of TMP CONVERT is strictly prohibited and will be sanctioned. TMP CONVERT reserves the right to add, modify or delete information to any time without warning.



www.jouplast.com

